



PETE'S
Party & Tent
RENTAL

315 Lorne Street, Sudbury, ON P3C 4R1

Phone: 705-673-7383 www.petesrentall.ca

LIGHTWALL SETUP INSTRUCTIONS

Setup Tips

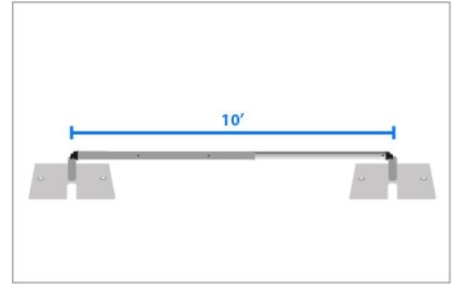
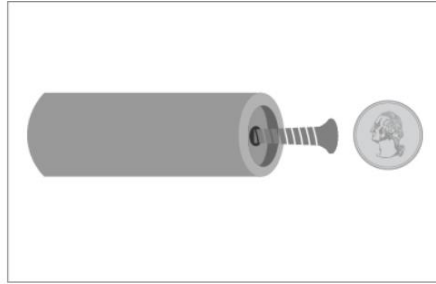
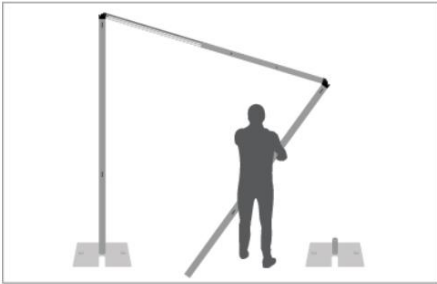

Setup Without a Ladder

Pipe and Drape can be set up from the floor (no matter how short you are) no ladder required! Attach the hook end into the top of the first upright. Holding the unattached end in your left hand, grab the other upright in your right hand and angle it in toward your body until you can comfortably attach the other hook then raise back up. For a long line of pipe and drape, you'll continue this movement down the line until complete.

No Tools Required

Don't have a screwdriver on hand? No worries, tradeshow professionals know the easiest way to tighten the screw when connected to the base is to use a quarter from your glove box. It's important to make sure the screw is tight, so your pin is secure, which helps keep the upright from wobbling.

Plan in 10ft Sections

Keep it simple by planning your Pipe and Drape section in 10ft increments. That way you can use your Drape Support adjusted out to 10ft as a measurement guide on where to set your base plates. This also makes calculating how many panels of drape you need easier.

1) Remove the screw from the bottom of the pins. Place the screw through the desired pinhole on the base and tighten the pins until secure. Place the base plates 6' to 10' apart depending on size of backdrop.

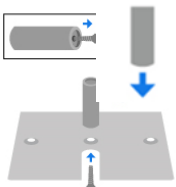

2) Slide upright onto back pin, front pin will be for other upright.

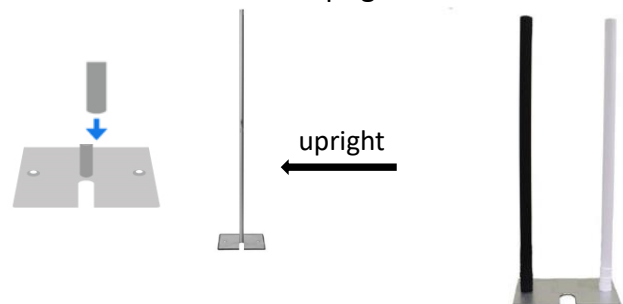

3) Crossbars extend to 6' to 10', the tab will click into the appropriate hole.

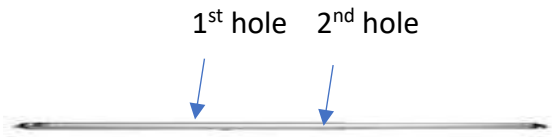

4) Put drape (solid ones) onto the back crossbar and spread evenly on crossbar.

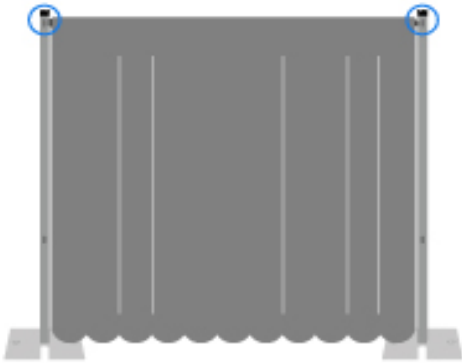

5) Hang the crossbar onto the slots found at the top of the uprights.

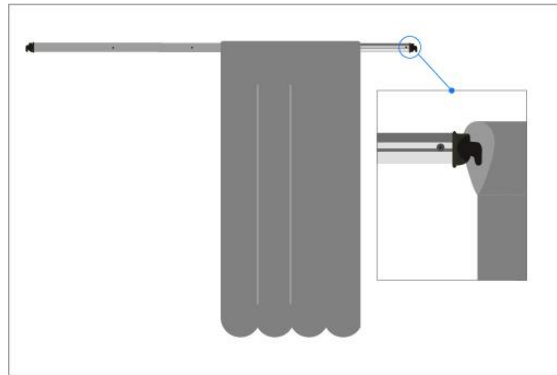

6) Now hang lights over drape on back crossbar using the "S" hooks provided to secure the lights. Hang lights onto the hooks. Make sure to check where the outlet is to plug in lights before you start to hang them.

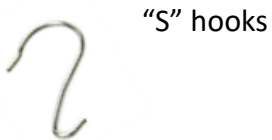

7) Place the next set of uprights onto the front pins. Extend the crossbar to the same size as the back bar and place the pieces of sheer onto the crossbar.

8) Hook the crossbar into the slots of the front uprights. Spread the sheer evenly across.

9) If you have any over draping you would hang this overtop of the sheer in whichever design you prefer. You may require additional sign hooks to do this.

